

KEL 10

Cable Entry Frames



Slit grommets



V2A
anti-corrosive

Also available with stainless steel screws (V2A).



Also available with threaded bushings.

1

IP54

Description	Type	Order No.	Grommets small large	PU
-------------	------	-----------	---------------------------	----

Product Description

Centrally split cable entry system for routing cables with connectors, providing an IP54 / up to NEMA type 12 rating. The slit grommet matching the cable diameter is placed around the cable and inserted into the cable entry frame. Either a cut-out of 36 mm or 46 mm in height can be chosen depending on the cables being routed. The split cable entry frame KEL 10 matches exactly the cut-out dimensions of 10-pin standard industrial connectors. A flat rubber gasket is included in the shipment.

Advantages & Benefits

- Warranty on pre-terminated cables remains
- Retrofits, repairs and maintenance can be done much more easily and quickly
- High cable density, wide variety of grommets
- Strain relief according to EN 62444
- High stability, vibration resistant

Specifications

Material	Polyamide (PA)
Flame class	UL94-Vo
IP rating	IP54, with gasket and correct selection of cable grommets (certified acc. to EN 60529)
NEMA type rating	NEMA type 12 (acc. to UL 50E)
Temperature	- 40°C to + 140°C (static) - 40°F to + 284°F (static)
Properties	Halogen-free, silicone-free
Cut-out dimensions	36/46 × 65 mm / Page 192 - 193
Frame depth	17 mm

Accessories

Cable grommets	44 - 48
KEL-SNAP Mounting frames	36 - 37
KEL-EMC Grounding mounts	122 - 124

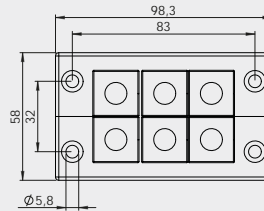

KEL 10|6

42216

6|-

10

KEL 10|6
with V2A screws

42216.200

6|-

10

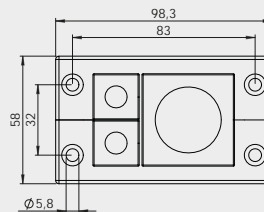

KEL 10|3

42212

2|1

10

KEL 10|3
with V2A screws

42212.200

2|1

10